



## SSF/SSH2653-Y

### 26.5" TFT LCD, LED Backlight 500nits, FHD(1920x1920)

The SSF/SSH2653-Y is a 26.5 inch color TFT-LCD display with special aspect ratio 1:1 and wide resolution 1920 x 1920. It is Litemax's Spanpixel series product which designed for high brightness with power efficiency LED backlight. It provides LCD panel with specific aspect ratios and sunlight readable for digital signage, public transportation, exhibition hall, department store, and vending machine.

#### Key Features

- High Brightness 500nits
- Sunlight Readable
- Aspect ratio 1:1
- LED Backlight
- Low Power Consumption
- Slim Bezel
- BL MTBF: 100,000 hours



### Specifications

<b>Model Name</b>	<b>SSF/SSH2653-Y V1</b>
<b>Description</b>	26.5" TFT LCD, 500nits LED Backlight, 1920x1920
<b>Screen Size</b>	26.5"
<b>Display Area (mm)</b>	475.776(H) x 475.776(V)
<b>Brightness</b>	500 cd/m <sup>2</sup>
<b>Resolution</b>	1920x1920
<b>Aspect Ratio</b>	1 : 1
<b>Contrast Ratio</b>	1200 : 1
<b>Pixel Pitch (mm)</b>	0.2478(H) x 0.2478(V)
<b>Pixel Pre Inch (PPI)</b>	102
<b>Viewing Angle</b>	178 °(H),178 °(V)
<b>Color Saturation (NTSC)</b>	81%
<b>Display Colors</b>	16.7M
<b>Response Time (Typical)</b>	14ms
<b>Panel Interface</b>	LVDS
<b>AD Board Input Interface</b>	DVI, HDMI, DP
<b>Input Power</b>	DC 12V
<b>Power Consumption</b>	44W, 51W (with AD board)
<b>OSD Key</b>	5 Keys (Power Switch, Menu, +, Exit, -)
<b>OSD Control</b>	Brightness, Color, Contrast, Auto Turing, H/V Position...etc
<b>Dimensions (mm)</b>	491.8 x 491.8 x 13.5
<b>Bezel Size(U/B/L/R)</b>	8/8/8/8 mm
<b>Weight (Net)</b>	2.5kg
<b>Operating Temperature</b>	0 °C ~ 50 °C
<b>Storage Temperature</b>	-20 °C ~ 60 °C

SSF= Panel + LED Driving Board

SSH= Panel + LED Driving Board + AD Control Board

*Specifications are subject to change without notice.*

*All brands or product names are trademarks or registered trademarks of their respective companies.*



## Mechanical Drawing

### Outline Dimensions

Unit:mm

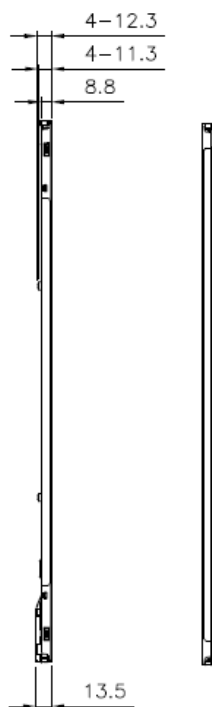
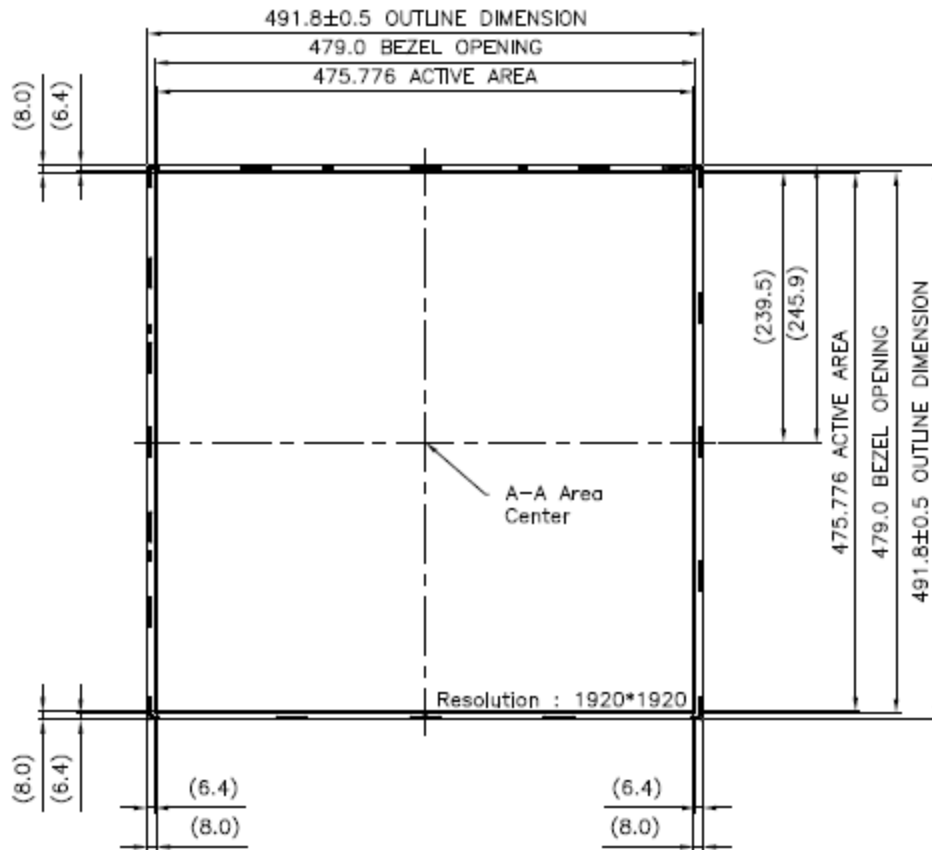

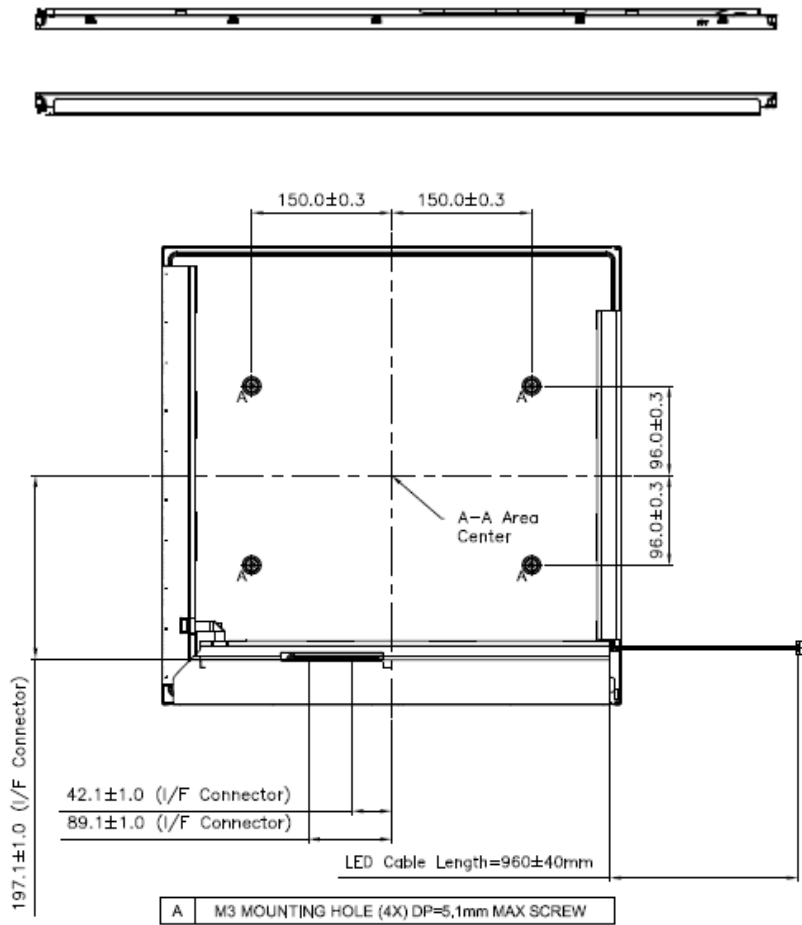

### Ordering Information

Part Number	Description
SSF2653-YNN-A01	26.5",500nits,1920x1920,LID26C,3in1,V1
SSH2653-YNN-M01	26.5",500nits,1920x1920,LID26C,AD9131DHP,DC12V,3in1,V1

### Optional Accessories

Part Number	Description
840612111201	ADAPTER.12V.10A.120W.G99-CAD120F-N002.POWER DIN,P
810618301010	CABLE.POWER.AC.1830mm USA type
810618301090	CABLE,POWER,AC,1830mm Europe type
810618301050	CABLE.POWER.AC.1830mm UK type
810618301170	CABLE.POWER,AC,1830mm Australia type
810618301031	CABLE.POWER.AC.1830mm Japan type

### Customer request

Touch	PCT (Multi-Touch)
Glass	Tempered glass,AR coating.....